

Cement Kilns

ECM ECO Monitoring, a.s. Bratislava (Slovak Republic) is focal company of the ECM Group consisting from a network of subsidiaries and offices to offer an optimal technical and commercial support on field of monitoring instrumentation of gases, liquids and particles.



- **Cement kiln probes**

In partnership with Enotec ECM is offering high quality cooled kiln probes. Periodic rotation of the probe is preventing problems with deposits and probe bending. Blowback and mechanical probe cleaning allows reliable long term operation with a minimum of maintenance. The probe can be provided with built – in O_2 and CO_e sensors, other gas compounds can be monitored by extractive analyzers connected using a heated sample hose.



- **Monitoring of O_2 and CO for safety purposes in coal mills, preheaters and precalciner**



- **CEMS: Continuous emission monitoring systems**

ECM is providing EN 14181 QAL1 certified CEMS solutions for all requested compounds

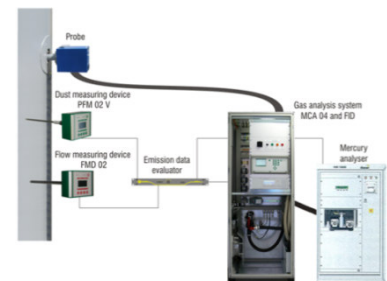

- **Dust monitoring for effective identification of failing filter bags:**



- **Monitoring of air flow carrying coal, limestone and cement dust in ducts at up to 1000°C temperatures**



- **Thermography for temperature analysis of the rotary kiln and of the cooler**

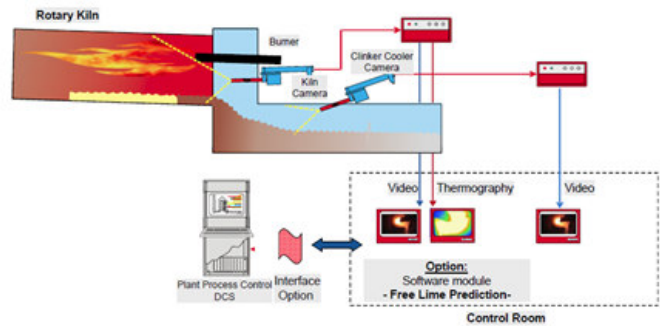

- **On-line elementary analysis of the minerals for cement production**

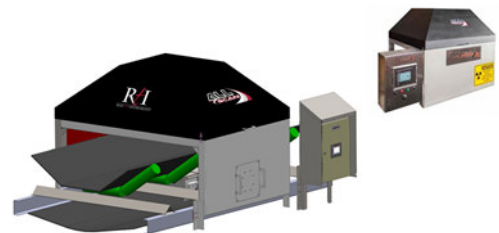

- **Instantaneous gas temperature measurement of cement kiln clinker cooler secondary Air**

The PyroMetrix Acoustic Pyrometer provides critical temperature information across entire line of sight that aids in managing air-fuel ratio and product quality.

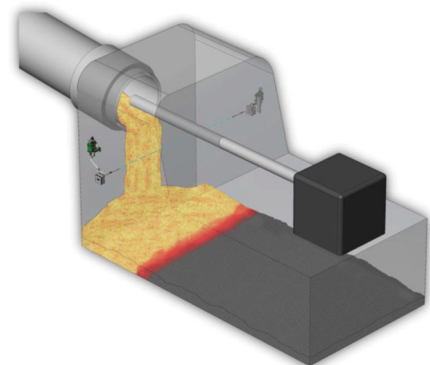

Contact:

ECM ECO Monitoring, a.s.
Nevádzová 5, 821 01 Bratislava,
Slovak Republic
Phone: +421 2 4822 4811
Fax: +421 2 4822 4823
E-mail: ecm@ecm.sk
www.ecomonitoring.com